

1.0/2.3 DIN - 47 297

1.0/2.3

DC - 10GHz

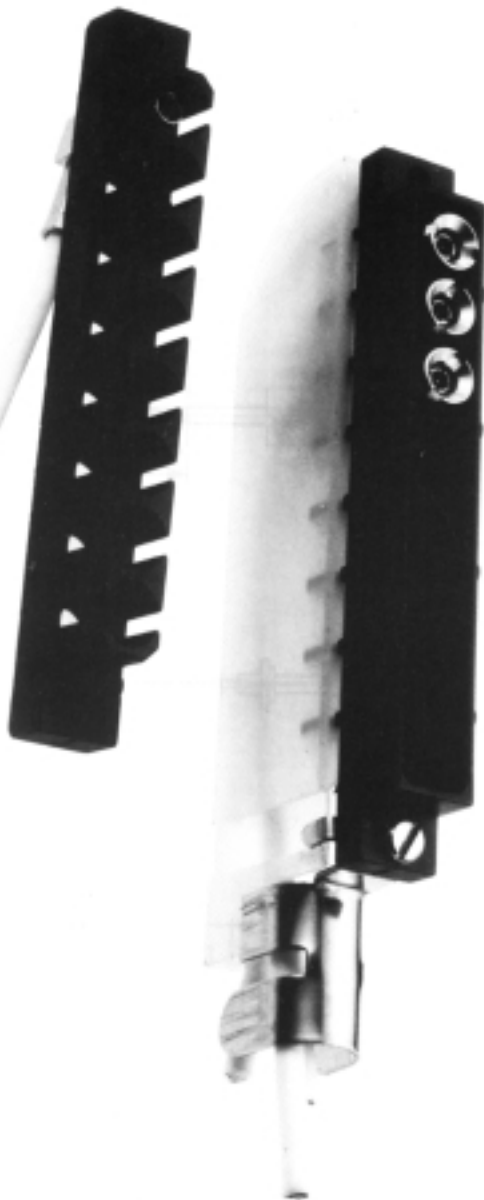

GENERAL

- Coaxial connectors belonging to miniature series
- Coaxial contacts according to DIN 41626 for assembly onto DIN 41612 PCB connectors and for mating with 1.0/2.3 coaxial connectors standard series

APPLICABLE STANDARDS

- DIN 47297
- CECC (draft)
- NF (draft)

APPROVALS

- LNZ list
- FTZ list

APPLICATIONS

- Civil telecommunications

1.0/2.3 DIN - 47 297

INTERFACE

PLUG

Diameter to meet gage test requirements

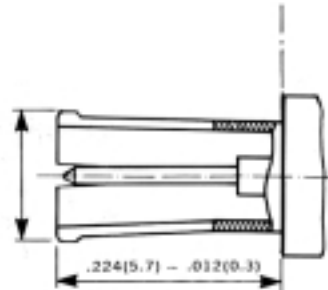

PIN

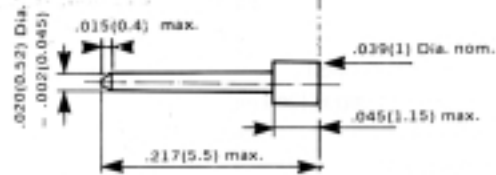

Electrical and mechanical reference plane

JACK

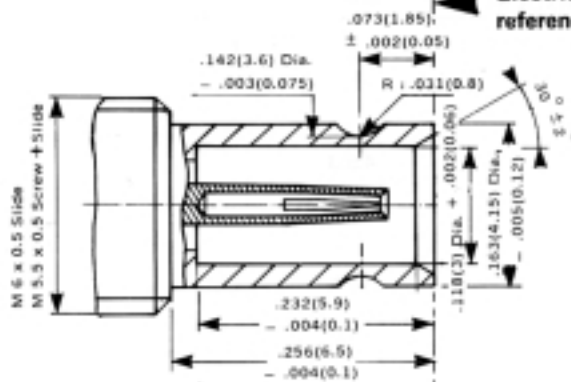

SPRING SOCKET

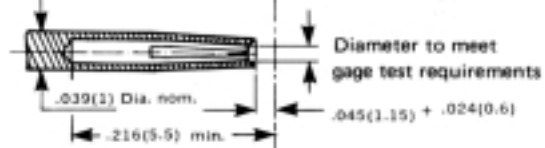

Diameter to meet gage test requirements

1.0/2.3 DIN - 47 297

CHARACTERISTICS

TEST/CHARACTERISTICS	CECC standard No 22 230	VALUES	COMMENTS
ELECTRICAL CHARACTERISTICS	4.4		General-purpose connectors
Frequency range		> 10 GHz	
Reflection factor	4.4.1		
Flexible cables			
– Up to 1 GHz		0,05 max.	
– Up to 4 GHz		0,07 max.	
– Up to 10 GHz		0,15 max.	
Semi-rigid cables			
– Up to 1 GHz		0,03 max.	
– Up to 4 GHz		0,06 max.	
– Up to 10 GHz		0,10 max.	
Resistance of center contact	4.4.2	≤ 4 mΩ initial +6 mΩ	Initial and after cond./test.
Continuity of outer conductor	4.4.3	≤ 2,5 mΩ initial +5 mΩ	Initial and after cond./test.
Insulation resistance	4.4.4	≥ 1 GΩ ≥ 200 MΩ	Initial and after cond./test.
Test voltage (sea-level)	4.4.5	750 V	
Test voltage at 70,000 ft (20 km)	4.4.6	150 V	
Recommended operating voltage (at sea-level)		250 V	
Recommended operating voltage at 70,000 ft (20 km)		65 V	
RF leakage (screen efficiency)	4.4.8		
MECHANICAL CHARACTERISTICS	4.5		
Captured contact	4.5.2		
– axial force		10 N	When specified
– torsional force		N.A.	
Static load (for connectors only)			
Mating/unmating	4.5.3	N.A.	
– unmating	4.5.4		
– mating		0,9 N min. 10 N max.	Screw-on and slide-on systems snap-on systems
Cabling	4.5.5		
– cable pull		A	
– cable torsion		N.A.	
Coupling mechanism strength	4.5.6	200 N 60 s.	If included in Detailed Spec.
Mechanical compatibility	4.5.7	A	
ENVIRONMENT	4.6		
Bumps	4.6.2	N.A.	
Vibrations	4.6.3	98 m/s ² 10 to 2000 Hz	10 g
Shocks	4.6.4	N.A.	
Climatic category	4.6.5	40/85/21	
Damp heat	4.6.6	insulation resistance 200 MΩ min.	
Splashproof (panel seal connectors)	4.6.8	1 cm ³ /h max.	Differential pressure 100 - 110 kPa
Hermeticity (hermetic connectors)	4.6.9	1 x 10 ⁻⁸ cm ³ /s.	Differential pressure 100 - 110 kPa
Corrosive environment (salt spray)	4.6.10	48 h	
Dust	4.6.11	N.A.	
Industrial environment	4.6.12	N.A.	
ENDURANCE	4.7		
Mechanical	4.7.1	500 cycles	
High temperature	4.7.2	85°C for 1000 h	

1.0/2,3 DIN - 47 297

COUPLING PROCEDURE

SCREW - ON

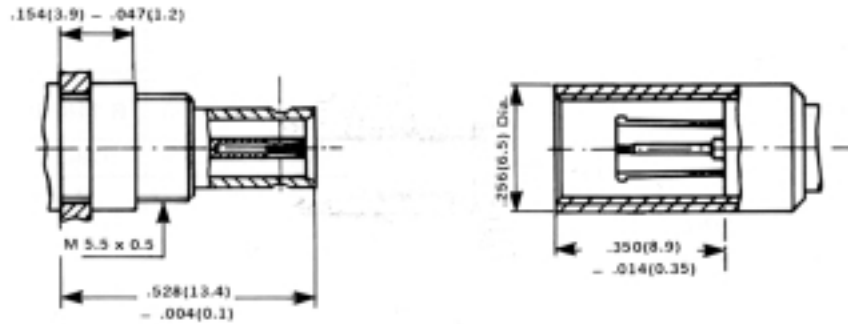

SNAP - ON

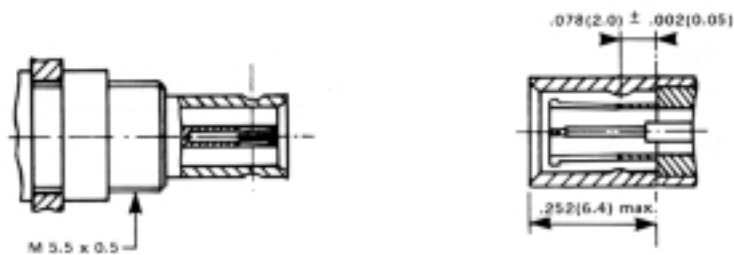

SLIDE - ON

